

S SERIES SPECIFICATIONS

STENNER PUMPS®

S30 Models

Shipping Weight
9 lbs (3.7 kg)

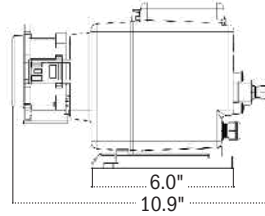
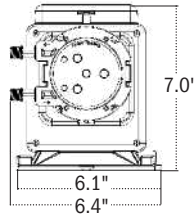

AGENCY LISTINGS



Intertek
94247
CONFORMS TO ANSI/NSF STD. 50
Equipment for swimming pools, spas, hot tubs and other recreational water facilities.

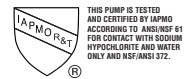

Listings vary by model

S40 Models

Shipping Weight
9 lbs (3.7 kg)

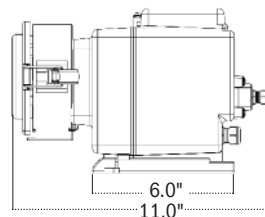
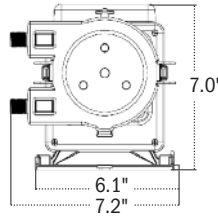

S50 Models

Shipping Weight
14 lbs (6.3 kg)

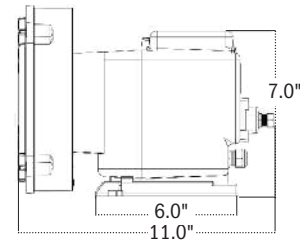
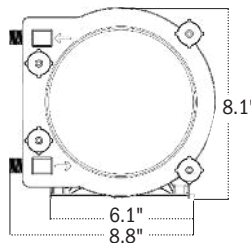

FEATURES

- Operational mode options: 4-20mA, 0-10VDC, dry contact, hall effect signals, cycle timer, 7 day/24 hour timer and manual
- Backup pump capability
- Standby input option to stop or start pump remotely
- Leak detection with dedicated output relay
- Modbus RTU over RS-485 capable (accessory required)
- Performance indicators with optional dry contact output relays
- Password protection
- Totally enclosed housing, NEMA 4X
- 2 year warranty
- Self-priming, does not lose prime or vapor lock
- Pumps off-gassing solutions and can run dry
- 3-point roller design assists with anti-siphon
- Output reproducibility

SPECIFICATIONS

- Flow Rate Output Control** Varies per control mode; digital keypad
- Reproducibility** ±2%
- Maximum Working Pressure** 25 psi (1.7 bar), 100 psi (6.9 bar)
- Maximum Operating Temperature** 104°F (40°C)
- Maximum Suction Lift** 25 ft (7.6 m) vertical lift, based on water
- Motor Type** Brushless DC motor
- Shaft rpm** (average maximum) 45
- Duty Cycle** Continuous
- Maximum Viscosity** 1500 Centipoise
- Motor Voltage (Amp Draw)**
120V 60Hz 1PH (0.6), 230V 50Hz 1PH (0.3)
- Hall Effect Max. Input Frequency** 100 KHz
- Pulse Duration Required** 10 milliseconds
Minimum duration required for pump to read signal.
- Power Cord Type** 120V 60Hz SJTOWA, 230V 50Hz H05RN-F
- Power Cord Plug End** 120V 60Hz 5-15P, 230V 50Hz CEE7/7
- Power Cord Length** 6 ft (1.8 m)
- Classification** Indoor/Outdoor

S SERIES SPECIFICATIONS

STENNER PUMPS®

MATERIALS OF CONSTRUCTION

All Housings Polycarbonate

Pump Tube (S30) Santoprene® (FDA approved), or Versilon®

Pump Tube (S40, S50) Santoprene® (FDA approved)

Check Valve Duckbill (S30) Santoprene® (FDA approved), or Pellethane®

Ball Check Valve Components (S40, S50)

- Ceramic ball (FDA approved); Tantalum spring; FKM seat & O-ring **OR**
- Ceramic ball (FDA approved); Stainless steel spring; EPDM seat; Santoprene® O-ring

Pump Head Rollers (S30, S40) Polyethylene **(S50)** Polycarbonate

Guide Rollers (S50) Polyethylene

Suction/Discharge Tubing, Ferrules 1/4" & 6 mm Polyethylene (FDA approved)

Tube Fittings, Injection Fittings PVC or Polypropylene (both NSF listed)

Connecting Nuts PVC or Polypropylene (both NSF listed)

3/8" Adapter (S30) PVC or Polypropylene (both NSF listed)

Suction Line Strainer and Cap PVC or Polypropylene (both NSF listed); ceramic weight

All Fasteners Stainless steel

Pump Head Latches (S30) Polypropylene **(S40)** Stainless steel

Pump Head Thumbscrews (S50) Stainless steel and PVC

Leak Detect Components (S30, S40) Hastelloy® **(S50)** Hastelloy® and stainless steel

Pump Head Support and Transition Sleeve (S50) Santoprene®

Tube Pull (S50) PVC

NOTE: Refer to the chemical guide for material compatibility.

Santoprene® is a registered trademark of Exxon Mobil Corporation. Versilon® is a registered trademark of Saint-Gobain Performance Plastics. Pellethane® is a registered trademark of Lubrizol Advanced Materials, Inc. Hastelloy® is a registered trademark of Haynes International, Inc.

ACCESSORIES

S30 Models

- 3 Connecting Nuts 1/4" & 3 Ferrules 1/4" or 6 mm *Europe* or 3 Connecting Nuts & 2 Adapters 3/8"
- 1 Injection Fitting 25 psi (1.7 bar) max. or 1 Duckbill Check Valve 100 psi (6.9 bar) max.
- 1 Weighted Suction Line Strainer 1/4", 3/8" or 6 mm *Europe*
- 20' Suction/Discharge Tubing 1/4" or 3/8", white or UV black or 20' Suction/Discharge Tubing 6 mm white *Europe*
- 1 Additional Pump Tube
- 2 Additional Latches
- 1 Mounting Bracket
- 1 Quick Start Guide

S40, S50 Models

- 3 Connecting Nuts & 2 Adapters 3/8"
- 1 Ball Check Valve 3/8"
- 1 Weighted Suction Line Strainer 3/8"
- 20' Suction/Discharge Tubing 3/8", white or UV black
- 1 Additional Pump Tube
- 1 Mounting Bracket
- 1 Quick Start Guide

Download S Series Manual www.stenner.com

FLOW RATE OUTPUTS

25 psi (1.7 bar) maximum

Model	Item Number Prefix	Pump Tube	Turndown Ratio	Gallons per Day	Gallons per Hour	Ounces per Hour	Ounces per Minute	Liters per Day	Liters per Hour	Milliliters per Hour	Milliliters per Minute
S3003	S3003	3	100:1	0.40-40.0	0.017-1.67	2.13-213.0	0.036-3.56	1.51-151.0	0.063-6.31	63.09-6309.0	1.05-105.0
S3004	S3004	4	100:1	0.60-60.0	0.025-2.50	3.20-320.0	0.053-5.33	2.27-227.0	0.095-9.46	94.64-9464.0	1.58-158.0
S3005	S3005	5	100:1	0.85-85.0	0.035-3.54	4.53-453.0	0.076-7.56	3.22-322.0	0.134-13.41	134.07-13,407.0	2.23-223.0
S405X	S405X	5X	100:1	1.5-150.0	0.06-6.25	8.0-800.0	0.13-13.33	5.7-567.0	0.24-23.66	236.59-23,659.0	3.94-394.0
S505G	S505G	5G	100:1	3.2-315.0	0.133-13.13	17.07-1680.0	0.284-28.00	12.11-1192.0	0.505-49.68	504.72-49,684.0	8.41-828.0

Approximate Outputs @ 50/60Hz

100 psi (6.9 bar) maximum

Model	Item Number Prefix	Pump Tube	Turndown Ratio	Gallons per Day	Gallons per Hour	Ounces per Hour	Ounces per Minute	Liters per Day	Liters per Hour	Milliliters per Hour	Milliliters per Minute
S3001	S3001	1	100:1	0.05-5.0	0.002-0.21	0.27-27.0	0.004-0.44	0.19-19.0	0.008-0.79	7.89-789.0	0.13-13.0
S3002	S3002	2	100:1	0.17-17.0	0.007-0.71	0.91-91.0	0.015-1.51	0.64-64.0	0.027-2.68	26.81-2681.0	0.45-45.0
S3007	S3007	7	100:1	0.40-40.0	0.017-1.67	2.13-213.0	0.036-3.56	1.51-151.0	0.063-6.31	63.09-6309.0	1.05-105.0
S407X	S407X	7X	100:1	0.60-60.0	0.03-2.50	3.2-320.0	0.053-5.34	2.3-227.0	0.09-9.46	94.64-9464.0	1.58-158.0
S507G	S507G	7G	100:1	1.3-125.0	0.054-5.21	6.93-667.0	0.116-11.11	4.92-473.0	0.205-19.72	205.04-19,716.0	3.42-329.0

Approximate Outputs @ 50/60Hz

! NOTICE: The information within this chart is solely intended for use as a guide. The output data is an approximation based on pumping water under a controlled testing environment. Many variables can affect the output of the pump. Stenner Pump Company recommends that all metering pumps undergo field calibration by means of analytical testing to confirm their outputs. The information contained in this flyer is not intended for specific application purposes. Stenner Pump Company reserves the right to make changes to prices, products, and specifications at any time without prior notice.